

INSTRUCTIONS

Table Top View Banners

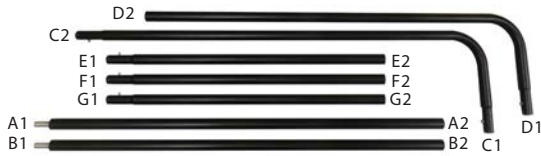

Includes:
Carry Bag
5 Sectional Straight Poles
2 Sectional Angled Poles
2 Clamps

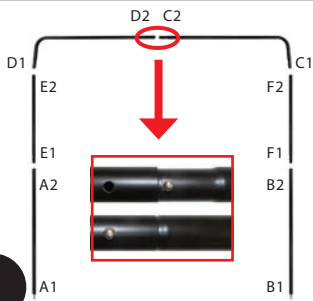

1

For 6' tables:
Connect sectional poles following the order listed above.*

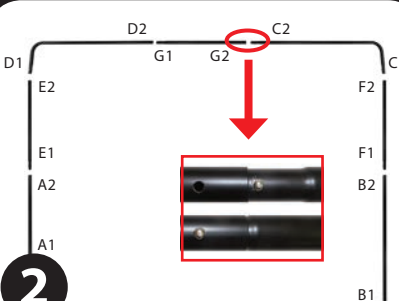

2

For 8' tables:
Connect sectional poles following the order listed above.*



3

Attach clamps H and I on the left and right (short) sides of your table. Turn lever to tighten clamp.



4

Slide graphic onto the assembled sectional pole frame.

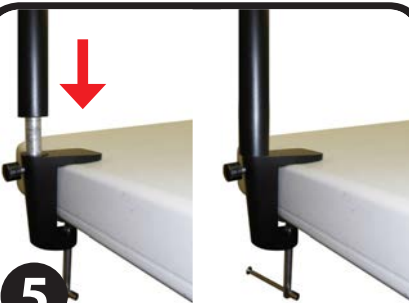

5

Slide poles A1 and B1 into the clamps on your table.



*For small and medium size banners, E and F sectional poles are optional when assembling.